

BOLE DK Series Two Platen Hybrid Injection Molding Machine

MODEL: BL650DK/Z4310

Measure Unit A B C

Injection Unit:

DESCRIPTION	UNIT	BL650DK/Z4310		
Screw diameter	in	2.95	3.35	3.54
	mm	75	85	90
Screw ratio		23	23	23
Theoretical injection capacity	cu in	113	145	163
	cm ³	1856	2383	2672
Shot weight(PS)	g	1707	2193	2458
	oz	60	77	87
Injection piston speed	in/s	4.37		
	mm/s	111		
Injection rate	cu in/s	30.0	38.5	43.1
	cm ³ /s	491	631	707
	g/s	452	580	650
Injection pressure	psi	34023	26488	23627
	Mpa	235	183	163
Max. Screw speed	r/min	158		

Clamping Unit:

Clamping force	US Ton	731
	kN	6500
Platen dimension	in x in	59.05 x 53.54
	mm x mm	1500 x 1360
Space between tie bar	in x in	41.73 x 36.2
	mm x mm	1060x920
Opening stroke	in	55/31.5
	mm	1400/800
Min. mold height	in	15.7
	mm	400
Max. mold height	in	39.4
	mm	1000
Max. daylight	in	70.9
	mm	1800
Ejector stroke	in	11.0
	mm	280
Ejector force forward	US Tons	26
	kN	232
Ejector force back	US Ton	17
	kN	155
Number of Ejector bar	PC	17

BOLE DK Series Two Platen Hybrid Injection Molding Machine
MODEL: BL650DK/Z4310

Measure Unit A B C

Other Machine Information:

Heater power	kW	32	38	42
Pump Motor	hp	33+63		
	kW	25+47		
System Pressure	PSI	2538/3045		
	MPa	17.5/21		
Dry cycle time/stroke(EUROMAP 6)	s/mm	3.2/742		
Oil reservoir capacity	Gal	238		
	L	900		
Max. mold weight	lbs	20944		
	kg	9500		
Net weight	Lbs	52000		
	Ton	26		
Machine size(LxWxH)	ft x ft x ft	30.5 x 10.5 x 9.5		
	m×m×m	9.3×3.2×2.9		

BOLE DK Series Two Platen Hybrid Injection Molding Machine
 MODEL: BL650DK/Z4310

Platen Size

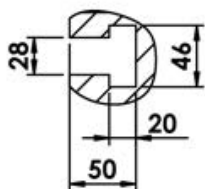
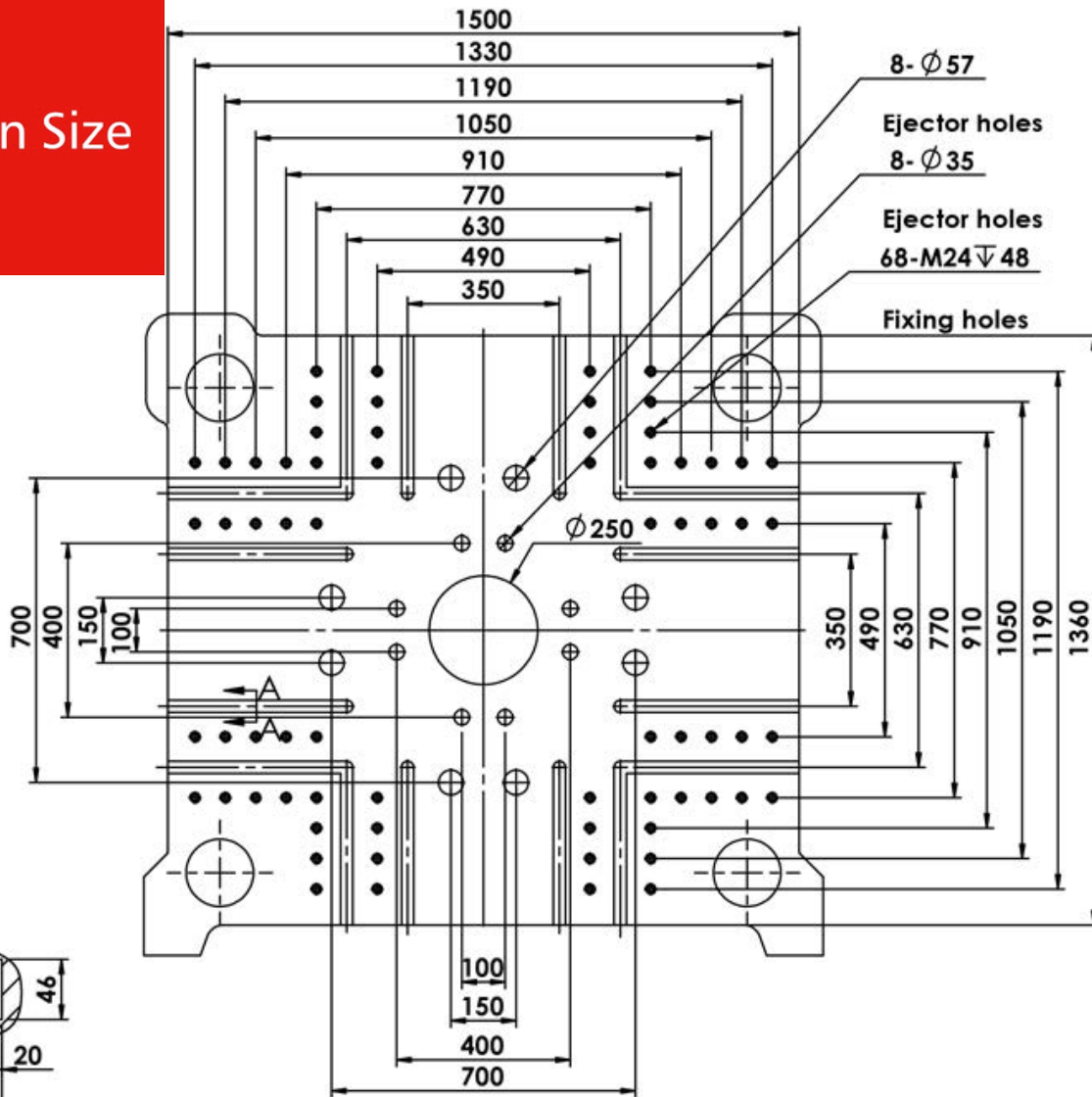

A-A T- slot

BL650DK

BOLE DK Series Two Platen Hybrid Injection Molding Machine
MODEL: BL650DK/Z4310

Platen
Side Size

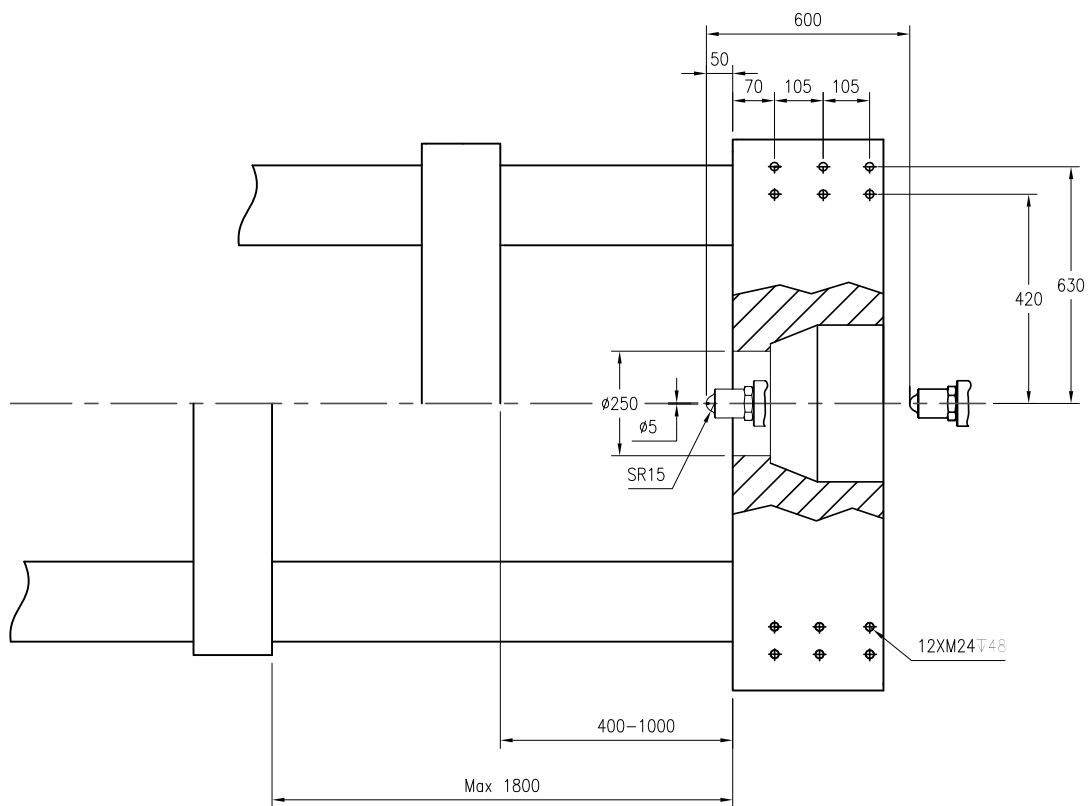

BL650DK